



# FlameStone Tower

Lake Paths | Fire Pit Areas | Focal Points

- Great Pathlight Alternative
- 60", 4x4 Powdercoated Steel, 29Lbs
- Includes U-Bracket & Stone
- Gel Flame Sold Separately
- Uplighting or Downlighting Options Available
- Mounting Options Available

Part #FST60 List Price: \$150





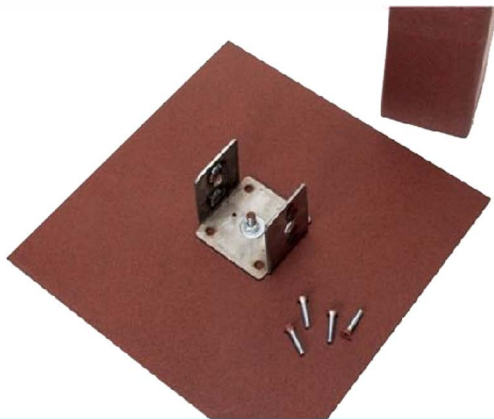

### FlameStone 10" Steel Baseplate Option

FST-BP

List Price: \$33



### FlameStone 14" Steel Auger Option

FST-AUGER

List Price: \$30



### Gel Flame 12 Pack ( Can lasts 2.5-3 Hrs)

SJPACK12

List Price: \$40

## Torch Mounting Options

#### Universal U-Bracket



The universal U-Bracket is for temporary mounting on a solid surface.

Included with every torch.

#### Option 1

#### Auger

The Aussie Auger Anchor is for temporary stabilization mounting. Since you don't have to dig or use cement, the Aussie Auger Anchor lets you install your fireplace without mess or sweat. The fastest, easiest, cleanest way to install your fireplace.

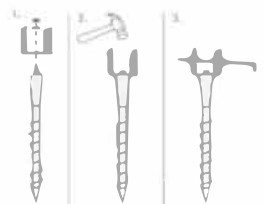

1. Attach Universal U-Bracket.

2. Place Auger. Use hammer to set the tip into the ground. Be sure to keep auger straight.

3. Slide metal turn bar through the Universal U-Bracket. Use the turn bar to twist the auger into the ground until U-Bracket is flush with ground.

#### Option 3

#### Stabilization Plate

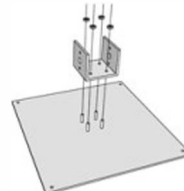

The stabilization plate mounting option includes: The Universal U-Bracket as well as a 14" stabilization plate for temporary mounting on a deck or patio surface.

Available for purchase separately

#### Option 2

Available for purchase separately