

EarthWay® Flex-Select®

Tray Setup and Calibration Techniques



How to Install a Tray

First ensure the hopper is clean and there is no debris trapped around the tray mounting area. Secondly install the Pivot Rod Clip¹ into the Shut-off of the selected Tray³. Next, insert the Pivot Rod² into the Clip¹. **TIP:** The Clip¹ may have a burr in the hole, use a Phillips screwdriver to remove the burr. See⁴ to make installing the Pivot Rod² easier. Pliers may be required to help squeeze the Pivot Rod² into the Clip¹. When the Rod² is secure inside the Clip¹ push the free end of the Clip¹ over the Pivot Rod² to firmly secure the rod to the clip. Next, install the Tray³ from the top downwards into the hopper (see figure⁵) positioning the center hole of the tray over the Pinion Shaft from the gear box with the Pivot Rod through the bottom of the hopper and facing toward the spreader's handlebar. For ease of locating into position the shut-off of the chosen tray is best in the open position, with the exception of the red **STANDARD-OUTPUT** Tray where the two adjustable throwing ports are best in the closed position.

NOTE: The gearbox can be moved along the axle to ease aligning of the tray hole and the pinion shaft. Once the tray is in place check that the tray is sealed and flush against the hopper sides. To check if the tray is properly located, push the tray edges downwards. Install the two quarter turn fasteners (see figure⁶) through the two exposed tray holes and push down and twist a quarter turn to secure.

Lastly, connect the free end of the Pivot Rod² into the Pivot linkage at the bottom of the Control Rod. Position the Clip¹ into the free hole and push the Pivot Rod² into the clip. **TIP:** The Clip¹ may have a burr in the hole, use a Phillips screwdriver to remove the burr (see figure⁴) When the Pivot Rod² is positioned inside the Clip¹ push the free end of the Clip¹ over the Pivot Rod² to firmly secure the rod and the clip together.

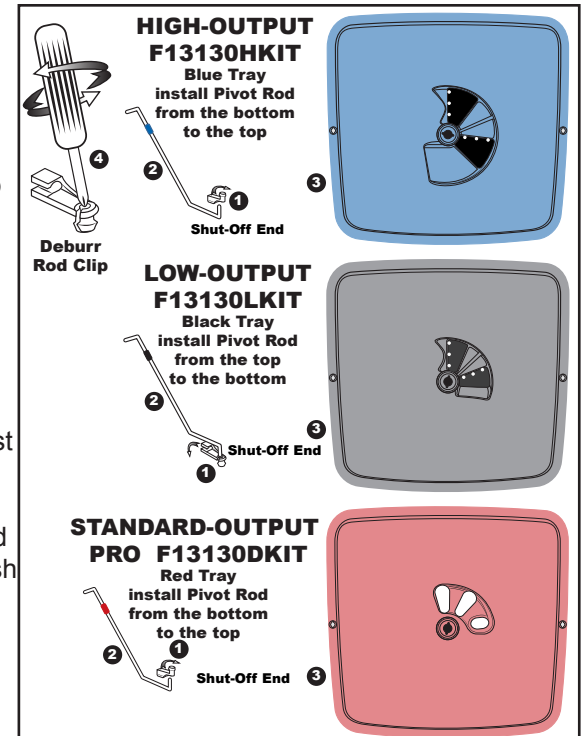

How to ensure your spreader is properly calibrated

HIGH-OUTPUT and LOW-OUTPUT Trays: Make sure the drop holes in the bottom of the hopper are **FULLY CLOSED** when the Rate Control Lever is resting on the Stop #0. If the shut-off is not set correctly, please adjust Control Rod at the Pivot to position the shut-off for **FULLY CLOSED** at position at the Stop #0 on the Rate Control Lever. **As a side note, the HIGH-OUTPUT and LOW-OUTPUT Trays do not include or use a horizontal agitator.**

Calibration Adjustment

Review the Control Lever position to confirm that it is set so that the forward edge of the Lever is resting at #0 (the stop) and the drop holes are closed. Move the spreader back & forth to ensure that the cam is positioned to allow the Oscillating Shut-off to close fully. If the shut-off is not properly positioned, you will need to adjust the Control Rod at the Pivot Bracket shown below.

TIP: If your shut-off is not able to **CLOSE** fully, loosen the top nut a few turns, then tighten the lower nut so that it allows you to push the **shut-off fully closed**. Next, tighten each nut so that they contact the pivot bracket without moving it, and then carefully tighten each nut fully so they do not loosen during use. Recheck adjustment as outlined above.

continued

12-2014 ~ F52157SC

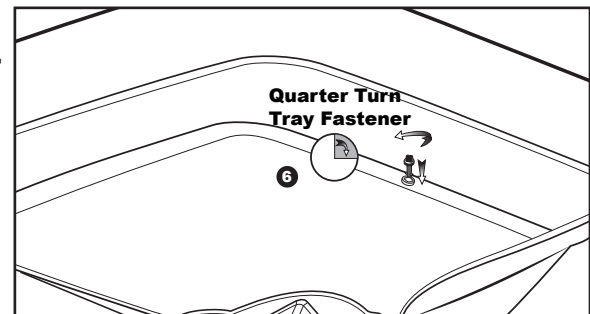
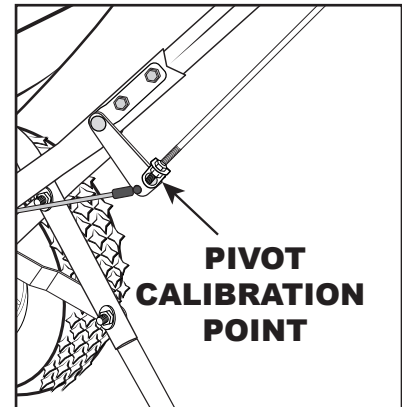
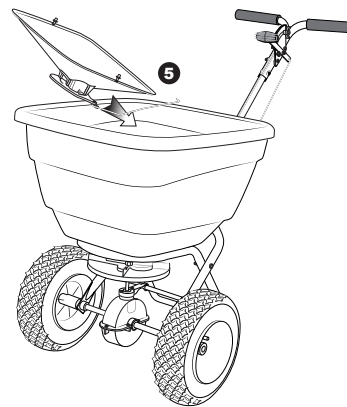

How to ensure your spreader is properly calibrated - continued

STANDARD-OUTPUT Tray: Make sure the drop holes in the bottom of the hopper are **FULLY OPEN** when the Rate Control handle is on #30. If the shut-off is not set correctly, please adjust Control Rod at the Pivot to position the shut-off for **FULLY OPEN** hopper position at #30 on the Rate Control Lever. Install the horizontal agitator through the pinion shaft in the hopper bottom. Finally, install the debris screen onto the Quarter-turn fasteners and push down to snap and secure.

Calibration Adjustment

Review the Control Lever position to confirm that it is set so that the rear edge of the Lever is resting at #30 (the stop) and the drop holes are open. If the shut-off is not properly positioned, you will need to adjust the Control Rod at the Pivot Bracket shown below. **TIP:** If your shut-off is not able to **OPEN** fully, loosen the bottom nut a few turns, then tighten the upper nut so that it allows you to push the **shut-off fully open**. Next, tighten each nut so that they contact the pivot bracket without moving it, and then carefully tighten each nut fully so they do not loosen during use. Recheck adjustment as outlined above.

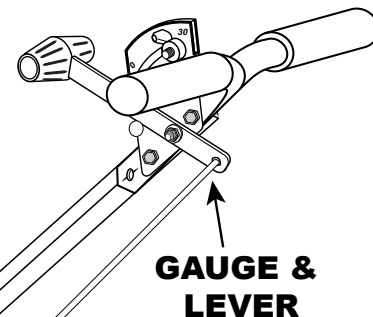
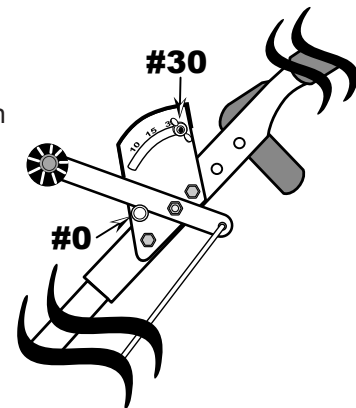
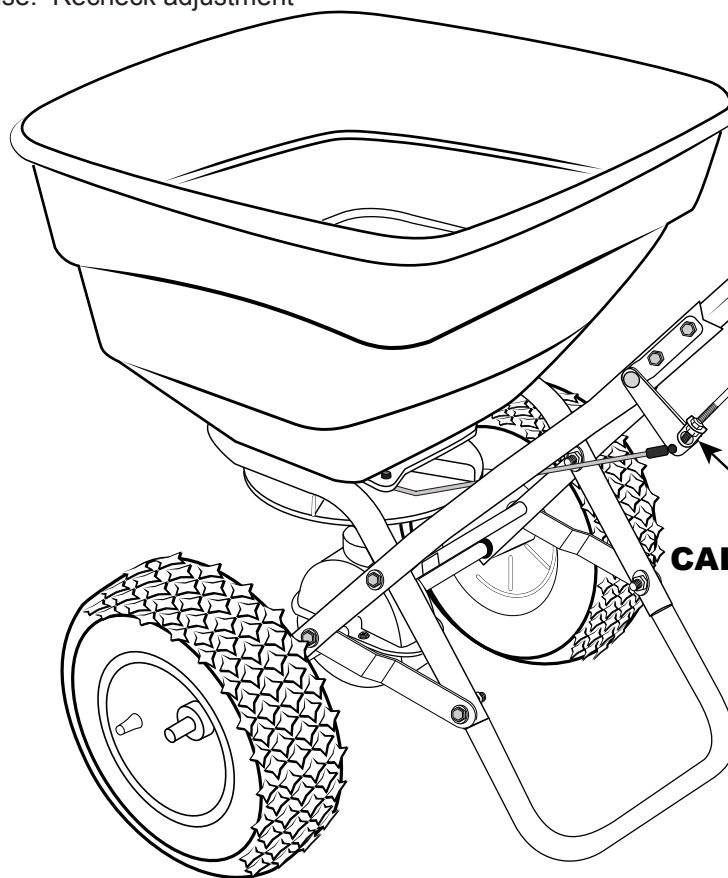

Control Lever Drag adjustment

If the Control Lever does not stay in position causing the setting rate to change without your intervention, you can adjust the drag on the Lever by tightening or loosening the nut shown to the right until the drag is appropriate.



If you have any questions regarding the assembly or safe operation your spreader, please contact us at 800-294-0671 or 574-848-7491 Monday - Friday 9:00am - 4:00pm Eastern, or email us at sales@earthway.com. If you are outside of the USA, please visit our web site www.earthway.com for guidance on a dealer local to you who can assist with your enquiry.

FLEX-SELECT® BROADCAST SPREADER SETTING MATRIX

GRANULAR MATERIAL

STANDARD-OUTPUT Red Tray

PARTICLE SIZES: Fine/Small →
(1/16" SAND)

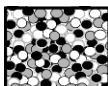

Medium →
(3/32")

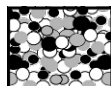

Large →
(1/8") ICE MELT

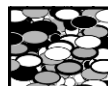

LBS. PER 1,000 SQUARE FEET	SETTING	SPREAD WIDTH FT	SPREAD METERS	SETTING	SPREAD WIDTH FT	SPREAD METERS	SETTING	SPREAD WIDTH FT	SPREAD METERS
1 LB.	7	18'	5.5m	9	24'	7.3m	14	36'	11m
2 LBS.	10	18'	5.5m	13	24'	7.3m	18	36'	11m
3 LBS.	13	18'	5.5m	16	24'	7.3m	23	36'	11m
4 LBS.	14	18'	5.5m	20	24'	7.3m	27	36'	11m
5 LBS.	16	18'	5.5m	22	24'	7.3m	30	36'	11m
6 LBS.	18	18'	5.5m	25	24'	7.3m	23 = 2 pass	36'	11m
7 LBS.	20	18'	5.5m	27	24'	7.3m	25 = 2 pass	36'	11m
8 LBS.	22	18'	5.5m	28	24'	7.3m	27 = 2 pass	36'	11m
9 LBS.	24	18'	5.5m	30	24'	7.3m	28 = 2 pass	36'	11m
10 LBS.	26	18'	5.5m	22 = 2 pass	24'	7.3m	30 = 2 pass	36'	11m

GRASS SEED



LBS. PER 1,000 SQUARE FEET	FINE SETTING	SPREAD WIDTH FT	SPREAD METERS	COARSE SETTING	SPREAD WIDTH FT	SPREAD METERS
2 LBS.	14	8'	2.4m	22	14'	4.3m
3 LBS.	16	8'	2.4m	25	14'	4.3m
4 LBS.	18	8'	2.4m	28	14'	4.3m
5 LBS.	20	8'	2.4m	30	14'	4.3m

Calibration: Start by ensuring that your spreader calibration is correct. Make sure the drop holes in the **Standard-Output Tray** are fully open when the Rate Control handle is on #30. If not, please adjust control rod at the pivot to allow for a full open hopper holes with the handle at position at #30.

GRANULAR MATERIAL

LOW-OUTPUT Black Tray

PARTICLE SIZES: Fine/Small →
(1/16" SAND)

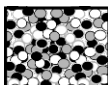

Medium →
(3/32")

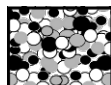

LBS. PER 1,000 SQUARE FEET	SETTING	SPREAD WIDTH FT	SPREAD METERS	SETTING	SPREAD WIDTH FT	SPREAD METERS
1 LB.	8	16'	4.9m	10	20'	6.1m
2 LBS.	10	16'	4.9m	13	20'	6.1m
3 LBS.	12	16'	4.9m	18	20'	6.1m
4 LBS.	13	16'	4.9m	20	20'	6.1m
5 LBS.	16	16'	4.9m	22	20'	6.1m
6 LBS.	18	16'	4.9m	25	20'	6.1m
7 LBS.	20	16'	4.9m	27	20'	6.1m
8 LBS.	21	16'	4.9m	29	20'	6.1m
9 LBS.	23	16'	4.9m	30	20'	6.1m
10 LBS.	24	16'	4.9m	22 = 2 pass	20'	6.1m

GRASS SEED



LBS. PER 1,000 SQUARE FEET.	FINE SETTING	SPREAD WIDTH FT	SPREAD METERS	COARSE SETTING	SPREAD WIDTH FT	SPREAD METERS
2 LBS.	15	9'	2.7m	21	15'	4.6m
3 LBS.	18	9'	2.7m	24	15'	4.6m
4 LBS.	21	9'	2.7m	27	15'	4.6m
5 LBS.	24	9'	2.7m	30	15'	4.6m

Calibration: Start by ensuring that your spreader calibration is correct. Make sure the drop holes in the **LOW-OUTPUT TRAY** are fully closed when the Rate Control Handle is resting on the stop #0. If not, please adjust control rod at the pivot to ensure the shut-off is fully closed with the handle at position at #0. Move the spreader slightly to confirm the calibration because of the cam.

GRANULAR MATERIAL

HIGH-OUTPUT Lt. Blue 2-hole Tray

PARTICLE SIZES: Large →
(1/8") ICE MELT

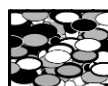

EXTRA LARGE →
ROCK SALT



LBS. PER 1,000 SQUARE FEET.	SETTING	SPREAD WIDTH FT	SPREAD METERS	SETTING	SPREAD WIDTH FT	SPREAD METERS
1 LB.	7	28'	8.5m	8	26'	7.9m
2 LBS.	10	28'	8.5m	11	26'	7.9m
3 LBS.	12	28'	8.5m	13	26'	7.9m
4 LBS.	14	28'	8.5m	14	26'	7.9m
5 LBS.	15	28'	8.5m	15	26'	7.9m
6 LBS.	17	28'	8.5m	16	26'	7.9m
7 LBS.	20	28'	8.5m	17	26'	7.9m
8 LBS.	21	28'	8.5m	18	26'	7.9m
9 LBS.	23	28'	8.5m	19	26'	7.9m
10 LBS.	24	28'	8.5m	21	26'	7.9m

Calibration: Start by ensuring that your spreader calibration is correct. Make sure the drop holes in the **HIGH-OUTPUT TRAY** are fully closed when the Rate Control Handle is resting on the stop #0. If not, please adjust control rod at the pivot to ensure the shut-off is fully closed with the handle at position at #0. Move the spreader slightly to confirm the calibration because of the cam.

FLEX-SELECT® BROADCAST SPREADER SETTING MATRIX

GRANULAR MATERIAL

STANDARD-OUTPUT Red Tray

PARTICLE SIZES: Fine/Small →
(1.5MM)

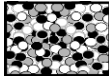

Medium →
(2.0MM)

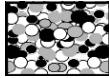

Large →
(3.0MM) ICE MELT

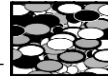

Grams PER Square Metre	SETTING	SPREAD WIDTH FT	SPREAD METRES	SETTING	SPREAD WIDTH FT	SPREAD METRES	SETTING	SPREAD WIDTH FT	SPREAD METRES
5	7	18	5.5	9	24	7.3	14	36	11.0
10	10	18	5.5	13	24	7.3	18	36	11.0
15	13	18	5.5	16	24	7.3	23	36	11.0
20	14	18	5.5	20	24	7.3	27	36	11.0
24	16	18	5.5	22	24	7.3	30	36	11.0
29	18	18	5.5	25	24	7.3	23 x 2 pass	36	11.0
34	20	18	5.5	27	24	7.3	25 x 2 pass	36	11.0
39	22	18	5.5	28	24	7.3	27 x 2 pass	36	11.0
44	24	18	5.5	30	24	7.3	28 x 2 pass	36	11.0
49	26	18	5.5	22 x 2 pass	24	7.3	30 x 2 pass	36	11.0

GRASS SEED



Grams PER Square Metre	FINE SETTING	SPREAD WIDTH FT	SPREAD METRES	COARSE SETTING	SPREAD WIDTH FT	SPREAD METRES
10	14	8	2.4	22	14	4.3
15	16	8	2.4	25	14	4.3
20	18	8	2.4	28	14	4.3
25	20	8	2.4	30	14	4.3

Calibration: Start by ensuring that your spreader calibration is correct. Make sure the drop holes in the **STANDARD-OUTPUT Tray** are fully open when the Rate Control handle is on #30. If not, please adjust control rod at the pivot to allow for a full open hopper holes with the handle at position at #30.

GRANULAR MATERIAL

LOW-OUTPUT Black Tray

PARTICLE SIZES: Fine/Small →
(1.5MM)

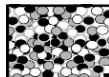

Medium →
(2.0MM)

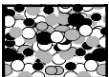

Grams PER Square Metre	SETTING	SPREAD WIDTH FT	SPREAD METRES	SETTING	SPREAD WIDTH FT	SPREAD METRES
5	8	16	4.9	10	20	6.1
10	10	16	4.9	13	20	6.1
15	12	16	4.9	18	20	6.1
20	13	16	4.9	20	20	6.1
24	16	16	4.9	22	20	6.1
29	18	16	4.9	25	20	6.1
34	20	16	4.9	27	20	6.1
39	21	16	4.9	29	20	6.1
44	23	16	4.9	30	20	6.1
49	24	16	4.9	22 x 2 pass	20	6.1

GRASS SEED



Grams PER Square Metre	FINE SETTING	SPREAD WIDTH FT	SPREAD METRES	COARSE SETTING	SPREAD WIDTH FT	SPREAD METRES
10	15	9	2.7	21	15	4.6
15	18	9	2.7	24	15	4.6
20	21	9	2.7	27	15	4.6
25	24	9	2.7	30	15	4.6

Calibration: Start by ensuring that your spreader calibration is correct. Make sure the drop holes in the **LOW-OUTPUT TRAY** are fully closed when the Rate Control Handle is resting on the **stop #0**. If not, please adjust control rod at the pivot to ensure the shut-off is **fully closed** with the handle at position at **#0**. Move the spreader slightly to confirm the calibration because of the cam.

GRANULAR MATERIAL

HIGH-OUTPUT Lt. Blue 2-hole Tray

PARTICLE SIZES: Large →
(3.0MM) ICE MELT

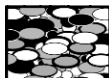

EXTRA LARGE →
ROCK SALT



Grams PER Square Metre	SETTING	SPREAD WIDTH FT	SPREAD METRES	SETTING	SPREAD WIDTH FT	SPREAD METRES
5	7	28	8.5	8	26	7.9
10	10	28	8.5	11	26	7.9
15	12	28	8.5	13	26	7.9
20	14	28	8.5	14	26	7.9
24	15	28	8.5	15	26	7.9
29	17	28	8.5	16	26	7.9
34	20	28	8.5	17	26	7.9
39	21	28	8.5	18	26	7.9
44	23	28	8.5	19	26	7.9
49	24	28	8.5	21	26	7.9

Calibration: Start by ensuring that your spreader calibration is correct. Make sure the 2 drop holes in the **HIGH-OUTPUT TRAY** are fully closed when the Rate Control Handle is resting on the **stop #0**. If not, please adjust control rod at the pivot to ensure the shut-off is **fully closed** with the handle at position at **#0**. Move the spreader slightly to confirm the calibration because of the

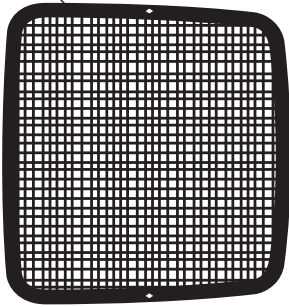

F40003 DEBRIS SCREEN
Included with both Standard Output
Trays only

STANDARD-OUTPUT F13130KIT

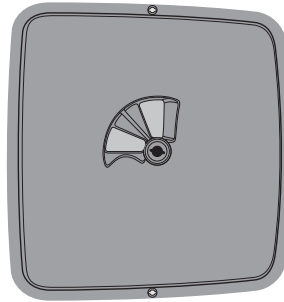
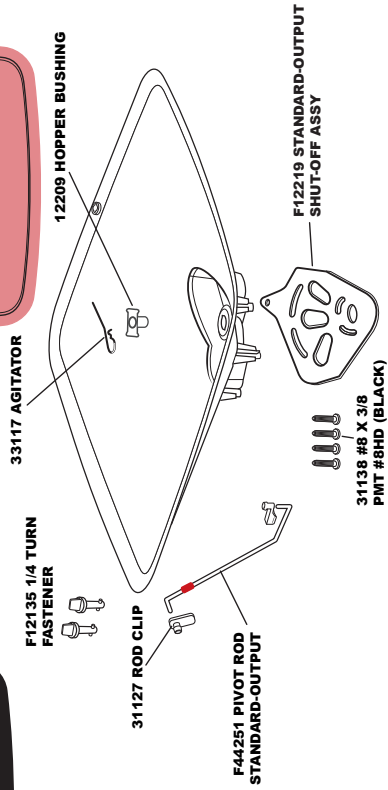

LOW-OUTPUT F13130LKIT

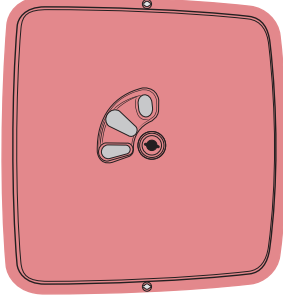
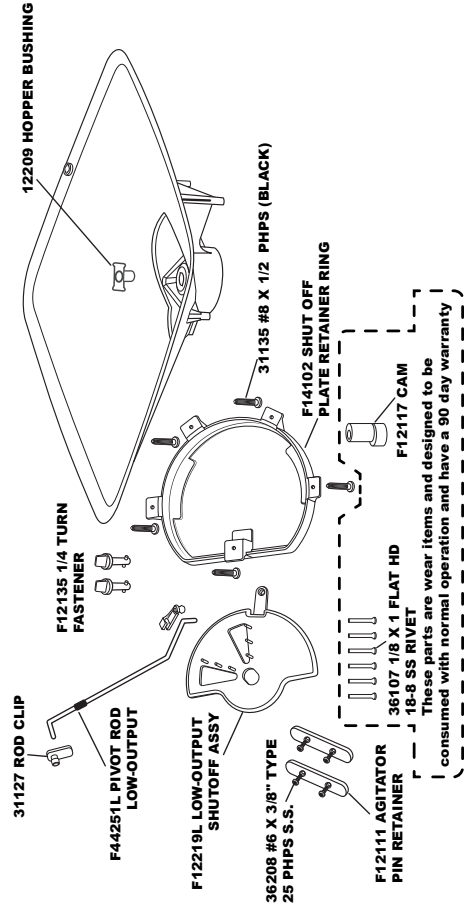

STANDARD-OUTPUT PRO F13130DKIT

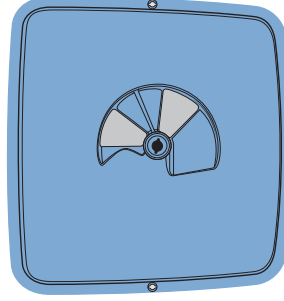
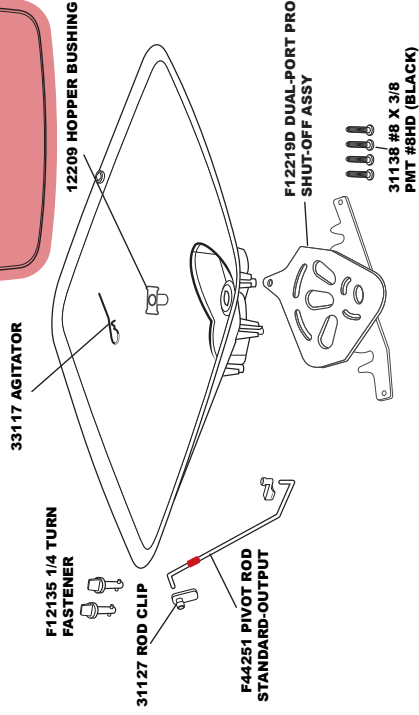

HIGH-OUTPUT F13130HKIT

