

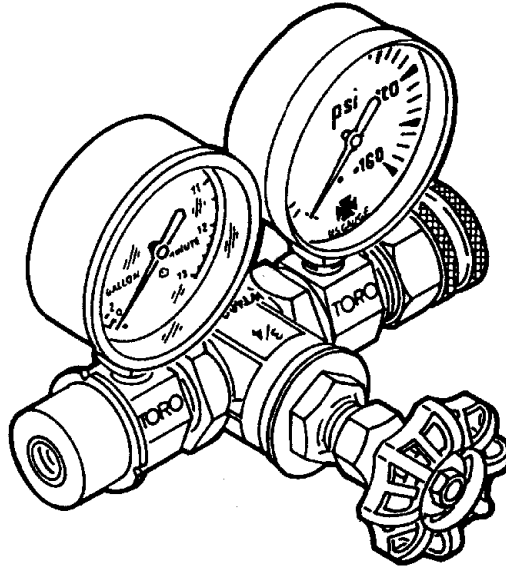

Operating and Service Instructions Flow Gauge Model 995-01, 53351

Introduction

The Toro flow gauge is a dual purpose device designed to measure water pressure to 160 PSI and water flow to 13 GPM. This flow gauge is not intended for use on lines larger than 1 inch (where a large volume of water is available). The gauge will only measure flow through the hose bib – not in the line.



CAUTION

To prevent damage to flow gauge, do not exceed 13 GPM or allow the flow gauge to freeze.

Operation

Note: Required system pressure information should be obtained before conducting flow check.

1. For best results; measure water flow at approximate time watering will be scheduled.
2. Ensure no water is being used at the location.
3. Attach gauge to hose bib nearest to point of sprinkler line connection.
4. Open control valve slightly to allow minimum flow.
5. Open hose bib slowly to avoid damage to gauges.
6. When hose bib is fully opened, close control valve and read system static pressure. Record this reading.
7. Open flow gauge slowly. As the control valve opens, pressure gauge will drop from the static reading and flow gauge will rise. Continue to open control valve until pressure drops to the required system pressure. Read and record PSI and GPM indicated on gauge.

Note: If rapid fluctuation occurs on flow gauge, record the average reading. Additional reading of pressure and flow may be helpful for further design information.

Flow Gauge

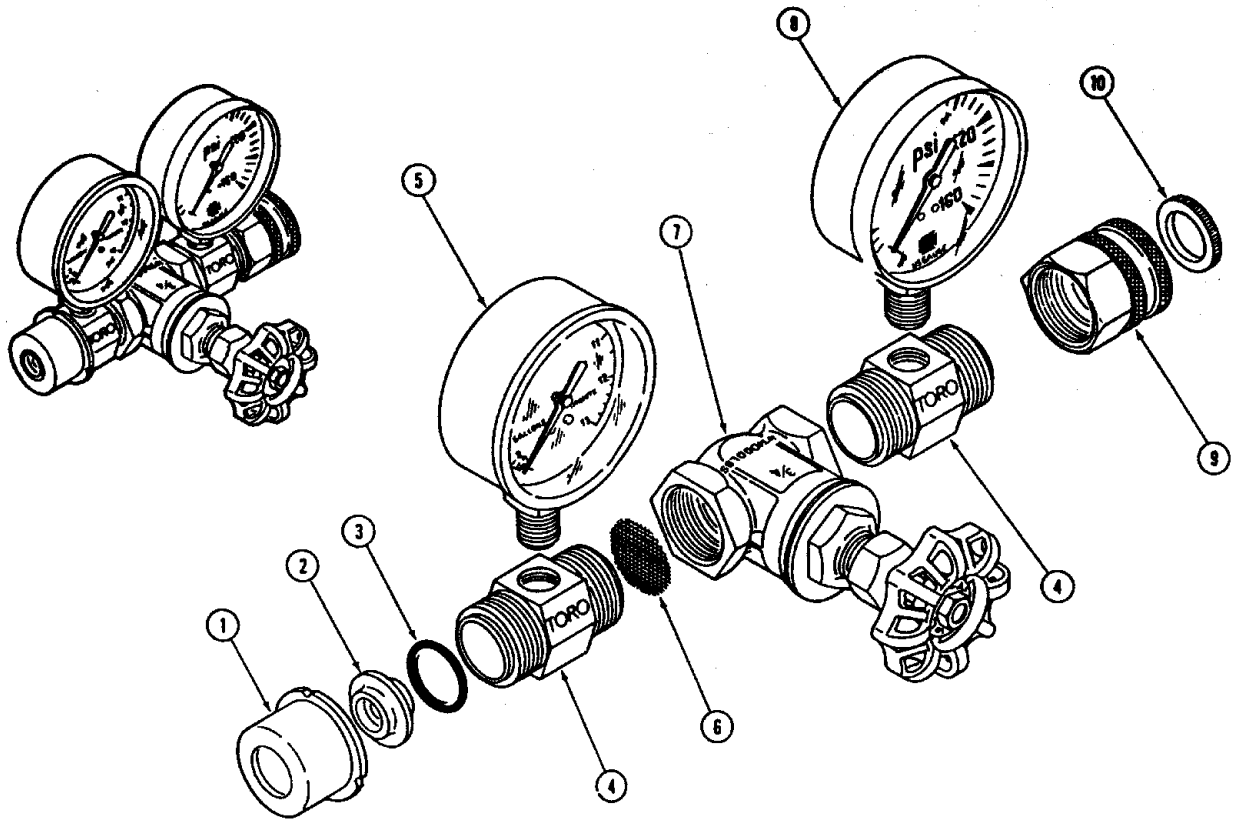

Item No.	Part No.	Nomenclature	Item No.	Part No.	Nomenclature
1	9-4576	Threaded Insert - 3/4 in.			
2	5-311	Orifice Plate			
3	360-0596	O-Ring			
4	9-6023	Nipple (Qty. of 2)			
5	5-309	Flow Gauge			
6	5-307	Filter Screen			
7	5-301	Gate Valve - 3/4 in.			
8	5-308	Pressure Gauge			
9	5-303	Hose to Pipe Fitting			
10	5-401	Hose Washer - 3/4 in.			



© 1993 THE TORO COMPANY
Irrigation Division
P.O. Box 489
Riverside, CA 92502
Printed in U.S.A.

PRINTING DATE
MAY 1994 REV. D

FORM NO.
362-0015