



MULTI FITTINGS

LAYING LENGTH

ISSUE DATE: MAY 10/05
SUPERCEDES: JAN 19/01

CAP

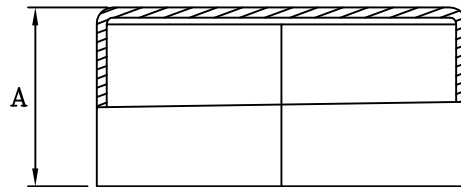
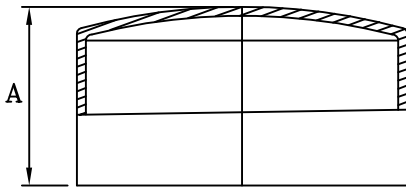

INJECTION MOLDED FITTING (M)

FABRICATED FITTING (F)

	SIZE	PART NUMBER	REFERENCE NUMBER	A REF	
M	3	040986	282939	1.625	056
M	4	040959	282947	2.125	084
M	6	040988	282962	3.625	084
M	8	040990	282988	5.375	084
M	10	040995	282910	5.500	056
M	12	040996	282912	6.500	056
F	15	040997	272915	12.500	082
	18	040998	-	-	P
	21	040985	-	-	P
	24	040917	-	-	P