

- NOTES:**
1. SEE CURLEY® SLOPE APPLICATION DETAIL SHEET FOR PROPER SLOPE INSTALLATION.
 2. STAPLE PATTERNS ARE DEPENDENT ON SITE CONDITIONS. SEE CURLEY® STAPLE PATTERN GUIDE FOR DETAILS.
 3. E-STAPLE® MAY BE USED IN PLACE OF WIRE STAPLES.

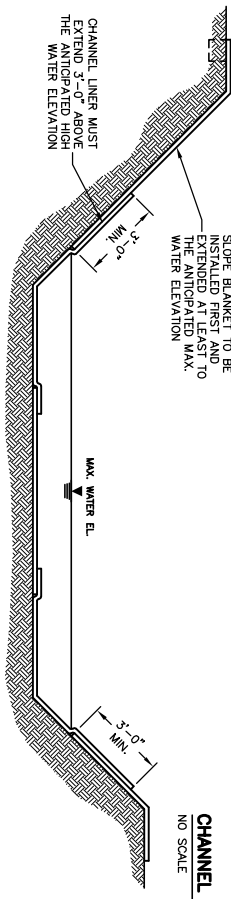

CHANNEL INSTALLATION METHOD "A"
NO SCALE

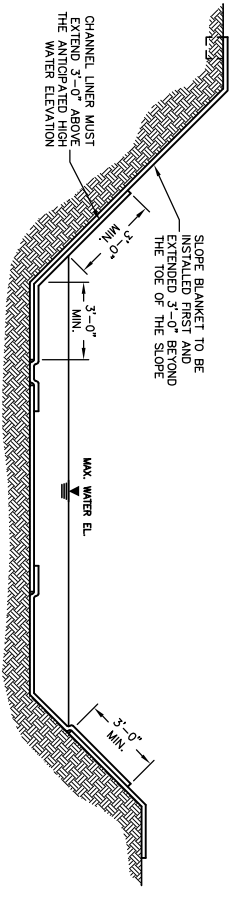

CHANNEL INSTALLATION METHOD "B"
NO SCALE

CHANNEL DETAIL
NO SCALE

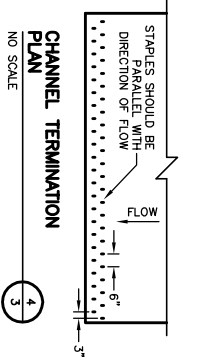

CHANNEL TERMINATION PLAN
NO SCALE

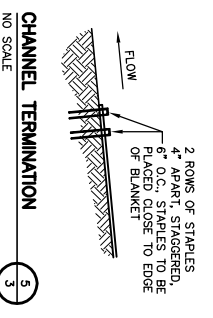

CHANNEL TERMINATION
NO SCALE

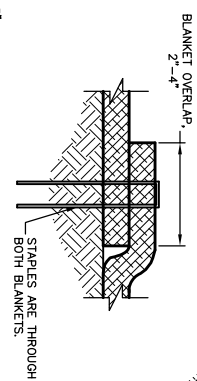

SIDE SEAM OVERLAP STAPLE DETAIL
NO SCALE

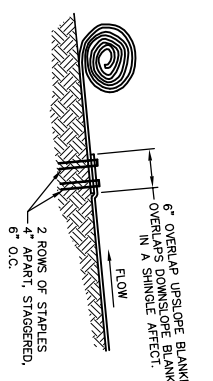

CHANNEL BLANKET END OF ROLL OVERLAP
NO SCALE

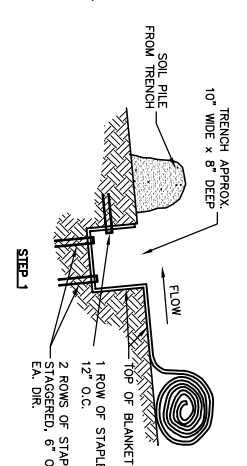

STEP 1

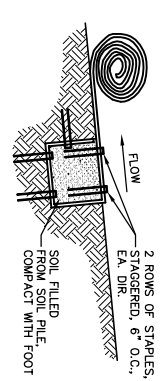

STEP 2

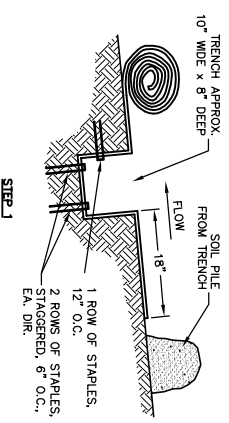

STEP 1

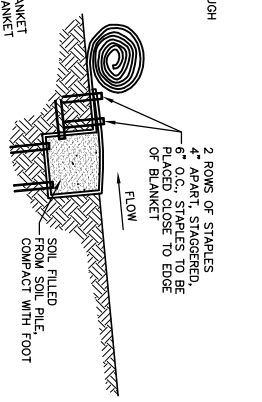

STEP 2

CHANNEL TRENCHING METHOD "A"
NO SCALE

CHANNEL TRENCHING METHOD "B"
NO SCALE

NO. OF REVISIONS	DATE	PROJECT	MANAGER	DATE 1/7/03	SCALE	DRAWN BY
		AMERICAN EXCELSIOR COMPANY	ARLINGTON, TEXAS		NONE	PROJECT NO. 3
						SHEET NO. 3

